



## Series 2805

Carbon Steel  
Needle Valve  
BSP Threaded

### FEATURES

MANUFACTURED IN TAIWAN (R.O.C.)

HEAVY PATTERN DESIGN

CARBON STEEL

FORGED TO SHAPE AND MACHINED

SUITABLE FOR APPLICATIONS WHERE FINE FLOW CONTROL IS REQUIRED

ALL VALVES PRESSURE TESTED DURING PRODUCTION

SIZE RANGE: 6MM TO 25MM

### PRESSURE AND TEMPERATURE RATINGS

TEMPERATURE RANGE: 0°C TO 200°C

MAXIMUM OPERATING PRESSURE AT NOMINAL TEMPERATURES: 6000 PSI (41,300kPa)

FOR RATINGS AT SPECIFIC TEMPERATURES REFER TO GRAPH OVERLEAF

# Series 2805

Carbon Steel Needle Valve

BSP Threaded

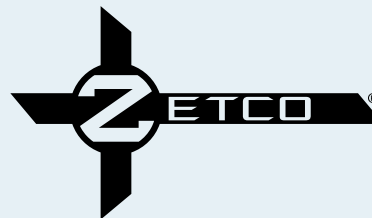

## DIMENSIONAL AND COMPONENT DIAGRAM

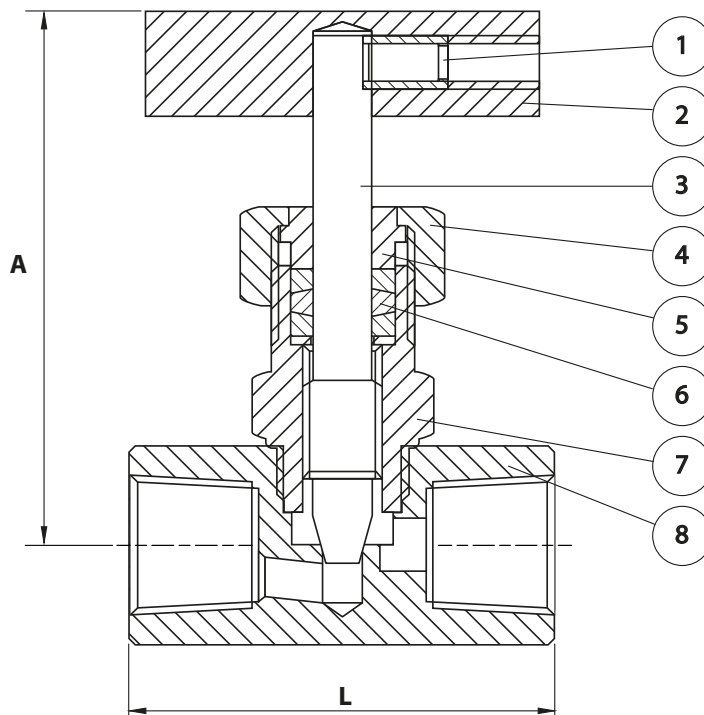

### MATERIALS

POS.	PART NAME	MATERIALS
1	SET SCREW	STAINLESS STEEL 304
2	HANDLE	STAINLESS STEEL 410
3	STEM	STAINLESS STEEL 316
4	GLAND NUT	STAINLESS STEEL 304
5	GLAND	STAINLESS STEEL 304
6	PACKING	PTFE
7	BONNET	CARBON STEEL
8	BODY	CARBON STEEL

### DIMENSIONS - mm

Prod. Code	Size	A	L	Kv	Wgt kg
2805003	3	75	58	0.60	0.403
2805006	6	75	58	0.69	0.383
2805010	10	75	58	0.77	0.364
2805015	15	87	65	1.03	0.568
2805020	20	90	70	1.12	0.698
2805025	25	103	80	1.55	1.28

### PRESSURE/TEMPERATURE DIAGRAM

