



Series 1008

Zetco WaterMarked
& AGA Approved
DZR Brass Ball Valve
M&F Lockable
Lever Handle

FEATURES

| |
|--|
| MANUFACTURED IN ITALY |
| FULL BORE |
| LOCKABLE HANDLE ALLOWS VALVE TO BE LOCKED IN OPEN OR CLOSED POSITION |
| WATERMARKED TO AS 5830.1 LICENCE WM-000110 |
| AUSTRALIAN GAS ASSOCIATION APPROVAL #5301 |
| BLOW-OUT PROOF STEM |
| MUST BE OPERATED IN FULLY OPEN OR CLOSED POSITION |
| ALL VALVES PRESSURE TESTED DURING PRODUCTION |
| SIZE RANGE: 6MM TO 50MM |

PRESSURE AND TEMPERATURE RATINGS

| |
|--|
| TEMPERATURE RANGE: -20°C TO 99°C |
| MAXIMUM OPERATING PRESSURE AT NOMINAL TEMPERATURES: |
| FLUIDS 2500 kPa |
| FOR RATINGS AT SPECIFIC TEMPERATURES REFER TO GRAPH OVERLEAF |
| GAS 2100 kPa |



AGA 5301
AS 4617



WaterMark

IAPMO WM-000110
AS 5830.1

Series 1008

Zetco WaterMarked & AGA Approved DZR
Brass Ball Valve M&F Lockable Lever Handle



DIMENSIONAL AND COMPONENT DIAGRAM

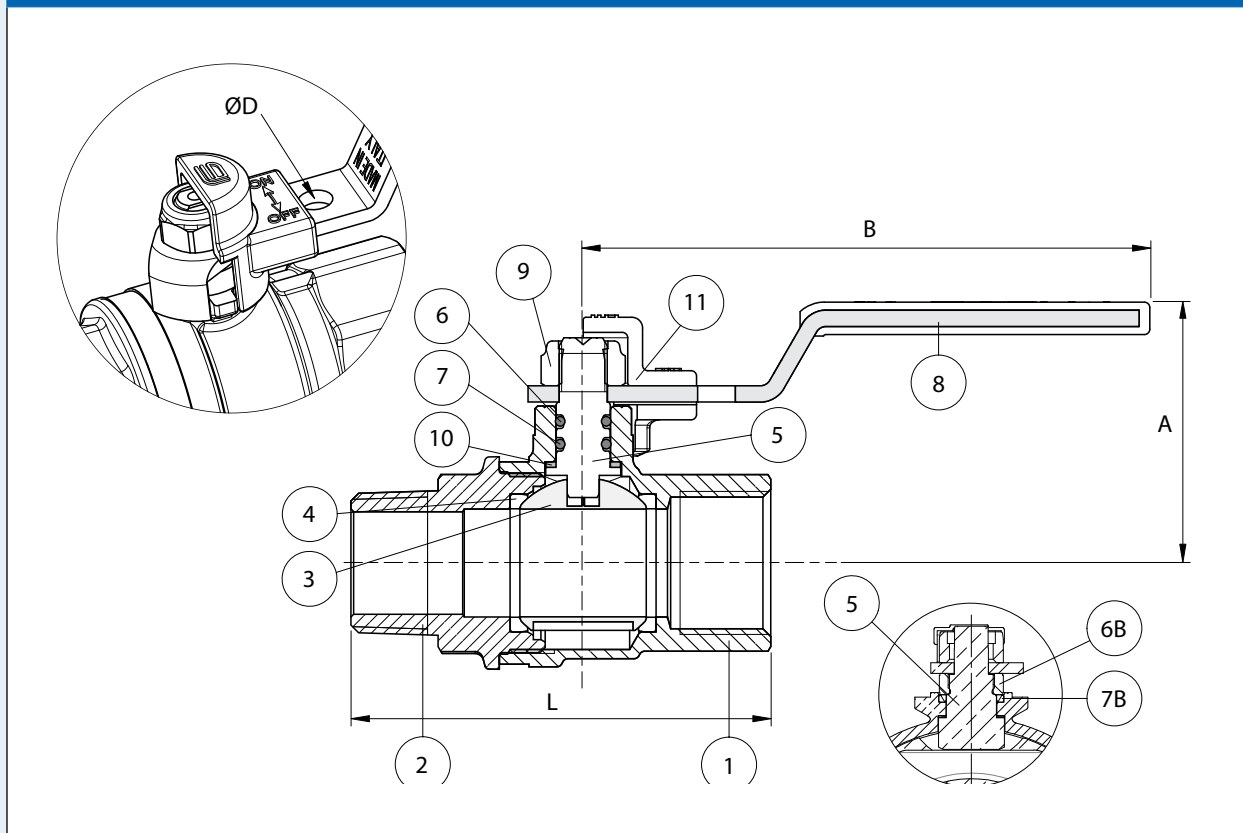

MATERIALS

| POS. | PART NAME | MATERIALS |
|------|-------------------|---------------------------|
| 1 | BODY | DZR BRASS |
| 2 | END ADAPTOR | DZR BRASS |
| 3 | BALL | DZR BRASS (CHROME PLATED) |
| 4 | SEAL | PTFE |
| 5 | STEM | DZR BRASS |
| 6A | UPPER O-RING | HNBR |
| 7A | LOWER O-RING | EPDM PEROXIDE |
| 6B | GLAND NUT | BRASS |
| 7B | CONICAL SEAL | PTFE |
| 8 | HANDLE | ZINC PLATED STEEL |
| 9 | NUT | ZINC PLATED STEEL |
| 10 | THRUST WASHER | PTFE |
| 11 | LOCKING MECHANISM | ZINC PLATED STEEL |

DIMENSIONS - mm

| Prod. Code | Size | A | B | L | ØD | Kv | Wgt kg |
|------------|------|----|-----|-----|----|-----|--------|
| 1008006 | 6 | 37 | 85 | 51 | 6 | 6 | 0.168 |
| 1008010 | 10 | 37 | 85 | 54 | 6 | 8 | 0.173 |
| 1008015 | 15 | 37 | 85 | 68 | 6 | 15 | 0.245 |
| 1008020 | 20 | 40 | 105 | 78 | 7 | 28 | 0.420 |
| 1008025 | 25 | 48 | 105 | 90 | 7 | 39 | 0.585 |
| 1008032 | 32 | 63 | 130 | 104 | 8 | 84 | 0.975 |
| 1008040 | 40 | 69 | 130 | 114 | 8 | 156 | 1.45 |
| 1008050 | 50 | 83 | 165 | 136 | 9 | 243 | 2.65 |

PRESSURE/TEMPERATURE DIAGRAM

